

**Package Details**  
SOD-723 Case

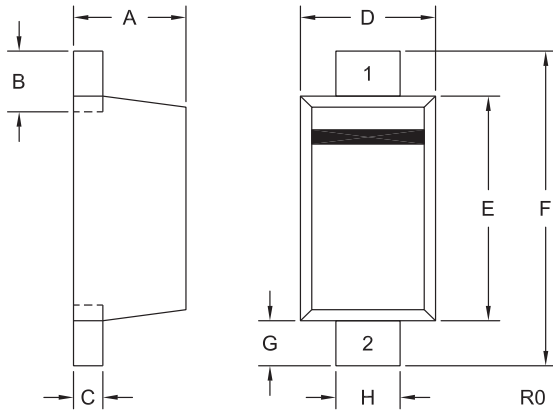

**Mechanical Drawing**



SYMBOL	INCHES		MILLIMETERS	
	MIN	MAX	MIN	MAX
A	0.017	0.022	0.45	0.55
B	0.007	0.015	0.18	0.38
C	0.003	0.007	0.08	0.18
D	0.021	0.026	0.55	0.65
E	0.037	0.042	0.95	1.05
F	0.053	0.057	1.35	1.45
G	0.006	0.010	0.15	0.25
H	0.009	0.013	0.25	0.32

SOD-723 (REV: R0)

**Lead Code:**

- 1) Cathode
- 2) Anode

**Part Marking:**

2-3 Character Alpha/Numeric Code

**Mounting Pad Geometry** (Dimensions in mm)

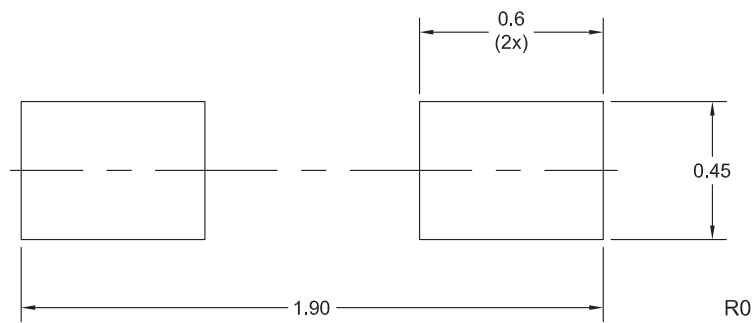

R0 (7-February 2012)

# Package Details

## SOD-723 Case



### Tape Dimensions and Orientation (Dimensions in mm)

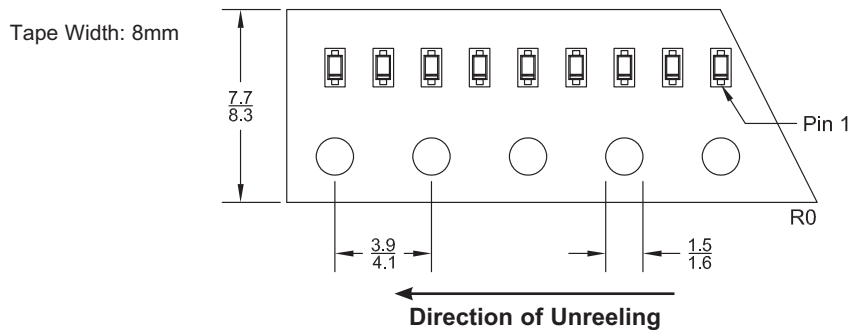

Devices are taped in accordance with Electronic Industries Association Standard EIA-481-D

### Packaging Base

7" Reel = 8,000 pcs.

### Reel Labeling Information

Each reel is labeled with the following information:

Central Part Number, Customer Part Number, Purchase Order Number, Quantity, Lot Number, Date Code, Ship Date and Marking Code.

### Reel Packing Information

Reel Size	Reels per Box (Maximum)	Parts per Box (Maximum)	Box Dimensions		Shipping Weight (Max.)	
			INCH	CM	LB	KG
7"	9	72,000	9x9x5	23x23x13	3	2
	18	144,000	9x9x9	23x23x23	6	3
	40	320,000	21x9x9	53x23x23	13	6
	108	864,000	27x9x17	69x23x43	34	16

### Ordering Information

- For devices taped and reeled on 7" reels, add TR suffix to part number.
- All SMDs are available in small quantities for prototype and manual placement applications.

R0 (7-February 2012)