

Package Details - TO-202 Thyristor

Mechanical Drawing

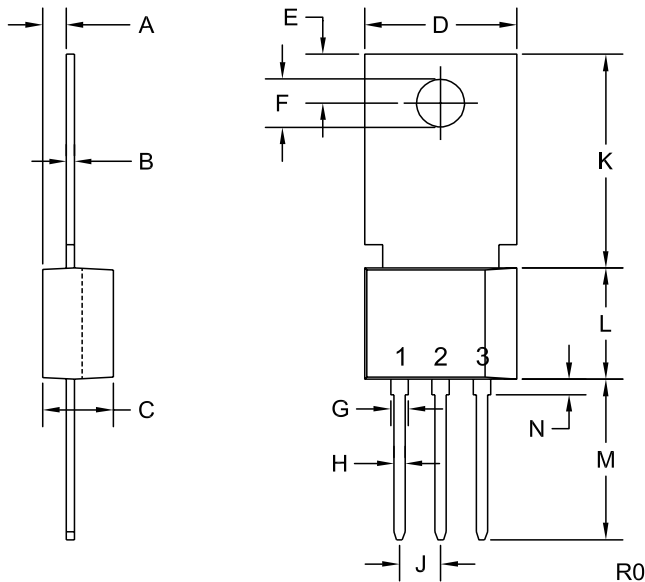

SYMBOL	DIMENSIONS			
	INCHES		MILLIMETERS	
	MIN	MAX	MIN	MAX
A	0.057	0.061	1.45	1.55
B	0.019	0.021	0.49	0.52
C	0.175	0.180	4.44	4.56
D	0.376	0.388	9.55	9.85
E	0.118	0.134	3.00	3.40
F (DIA)	0.124	0.126	3.15	3.20
G	0.035	0.043	0.90	1.10
H	0.023	0.028	0.59	0.71
J	0.098	0.102	2.49	2.59
K	0.459	0.559	11.66	14.21
L	0.280	0.301	7.12	7.65
M	0.406	0.425	10.30	10.80
N	0.024	0.059	0.60	1.50

TO-202 Thyristor (REV: R0)

LEAD CODE:

TRIAC

- 1) MT1
- 2) MT2
- 3) GATE

SCR

- 1) CATHODE
- 2) ANODE
- 3) GATE

Packing Information

Standard: Bulk

Devices are bulk packed in white corrugated box with black conductive coating (surface resistivity of $<10^5$ ohms per square).

Standard Packing Quantity: 500

Material Composition Specification

TO-202 Transistor Case



Device average mass **1438 mg**
 Fluctuation margin **+/-10%**

Component	Material	Material		Substance	CAS No.	Substance		
		(%wt)	(mg)			(%wt)	(mg)	(ppm)
active device	doped Si	0.08%	1.2	Si	7440-21-3	0.083%	1.2	834
bond wire	aluminum	0.28%	4	Al	7429-90-5	0.278%	4	2,782
leadframe	Cu alloy 194 w/ silver plating	56.68%	815	Cu	7440-50-8	55.216%	794	552,156
				Fe	7439-89-6	1.307%	18.8	13,074
				Zn	7440-66-6	0.07%	1	695
				P	7723-14-0	0.056%	0.8	556
				Ag	7440-22-4	0.028%	0.4	278
encapsulation*	EMC	40.82%	587	silica	7631-86-9	29.798%	428.5	297,983
				epoxy resin	Proprietary	9.388%	135	93,880
				Sb ₂ O ₃	1309-64-4	0.817%	11.75	8,171
				TBBA	79-94-7	0.817%	11.75	8,171
	EMC GREEN	40.82%	587	silica (fused)	60676-86-0	34.701%	499	347,010
				epoxy resin	Proprietary	2.594%	37.3	25,939
				phenol resin	9003-35-4	2.594%	37.3	25,939
				epoxy, cresol novolac	29690-82-2	0.814%	11.7	8,136
				carbon black	1333-86-4	0.118%	1.7	1,182
	plating**	tin/lead process	2.14%	30.8	Sn	7440-31-5	1.711%	24.6
Pb					7439-92-1	0.431%	6.2	4,312
100% matte tin		2.14%	30.8	Sn	7440-31-5	2.142%	30.8	21,419

*EMC GREEN molding compound is Halogen-Free.

**For Lead Free plating, add suffix "LEAD FREE" to part number.

For Tin/Lead plating, add suffix "TIN/LEAD" to part number.

No suffix designation allows for the supply of either lead-free or tin/lead plated product depending on availability.

Disclaimer

The information provided in this Material Composition data sheet is, to the best of our knowledge, correct. However, there is no guarantee to completeness or accuracy, as some information is derived from data sources outside the company.

R1 (3-June 2011)