

Package Details
MELF Case

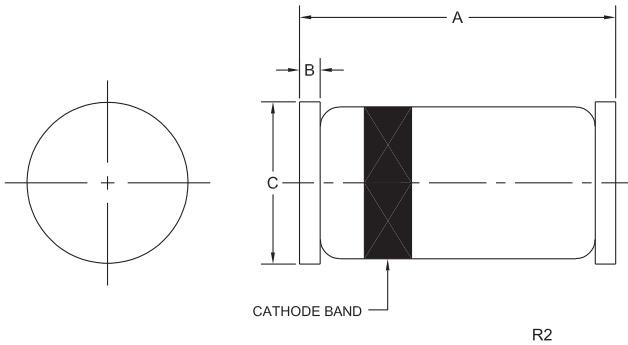

Mechanical Drawing



SYMBOL	DIMENSIONS			
	INCHES		MILLIMETERS	
	MIN	MAX	MIN	MAX
A	0.185	0.217	4.70	5.50
B	0.012	0.022	0.30	0.56
C (DIA)	0.094	0.110	2.40	2.80

MELF (REV:R2)

Part Marking: Cathode Band

Mounting Pad Geometry (Dimensions in mm)

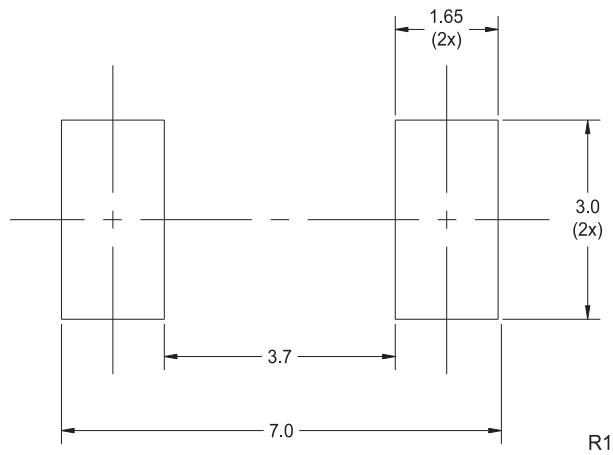

R2 (4-March 2010)

Package Details

MELF Case



Tape Dimensions and Orientation (Dimensions in mm)

Tape Width: 12mm

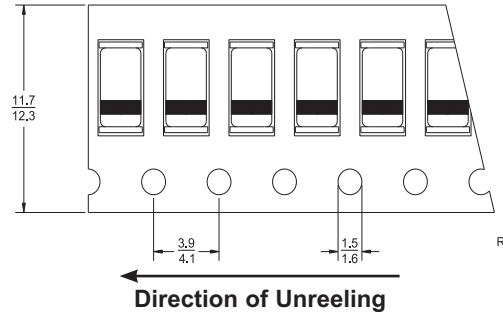

Devices are taped in accordance with Electronic Industries Association Standard EIA-481-1-A

Packaging Base

7" Reel = 1,500 pcs.

Reel Labeling Information

Each reel is labeled with the following information:

Central Part Number, Customer Part Number, Purchase Order Number, Quantity, Lot Number, Date Code and Ship Date.

Reel Packing Information

Reel Size	Reels per Box (Maximum)	Parts per Box (Maximum)	Box Dimensions		Shipping Weight (Max.)	
			INCH	CM	LB	KG
7"	6	9,000	9x9x5	23x23x13	6	3
	13	19,500	9x9x9	23x23x23	11	5
	32	48,000	21x9x9	53x23x23	27	13
	82	123,000	27x9x17	69x23x43	68	31

Ordering Information

- For devices taped and reeled on 7" reels, add TR suffix to part number.
- All SMDs are available in small quantities for prototype and manual placement applications.

R2 (4-March 2010)

Material Composition Specification

MELF Case



Device average mass 150 mg
 Fluctuation margin +/-10%

Component	Material	Material		Substance	CAS No.	Substance		
		(%wt)	(mg)			(%wt)	(mg)	(ppm)
active device	doped Si	0.17%	0.25	Si	7440-21-3	0.17%	0.25	1,667
leadframe	Fe alloy	62.67%	94	Fe	7439-89-6	27.73%	41.6	277,333
				Ni	7440-02-0	24.6%	36.9	246,000
				Cu	7440-50-8	10.33%	15.5	103,333
encapsulation	glass	36.4%	54.6	Pb	7439-92-1	20%	30	200,000
				O	7782-44-7	8.73%	13.1	87,333
				Si	7440-21-3	6.67%	10	66,667
				K	7440-09-7	1.0%	1.5	10,000
plating*	tin/lead process	0.77%	1.15	Sn	7440-31-5	0.61%	0.92	6,133
				Pb	7439-92-1	0.15%	0.23	1,533
	matte tin	0.77%	1.15	Sn	7440-31-5	0.77%	1.15	7,667

*For Lead Free plating, add suffix "PB FREE" to part number.
 For Tin/Lead plating, add suffix "TIN/LEAD" to part number.
 No suffix designation allows for the supply of either lead-free or tin/lead plated product depending on availability.

Disclaimer

The information provided in this Material Composition data sheet is, to the best of our knowledge, correct. However, there is no guarantee to completeness or accuracy, as some information is derived from data sources outside the company.

R5 (16-July 2018)